

## Depressor Kit for Filtration Recovery System (FRS)

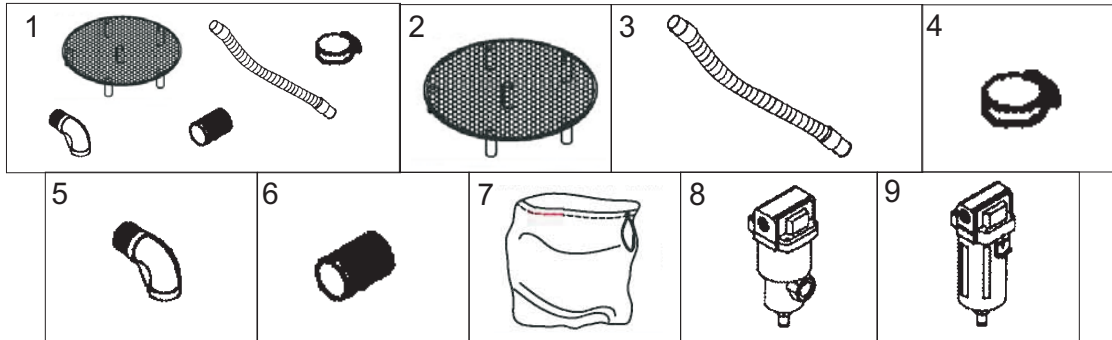

1	214240 214245 214248	Depressor Kit for poly liner (complete). For models FRS-17 STD series Depressor Kit for poly liner (complete). For models FRS-40 STD series Depressor Kit for poly liner (complete). For models 2D-20 (DT) MFS and AV-20 (DT) MFS	
2	213050B 213898B	Depressor Screen ø38cm. Stainless Steel. For models FRS-17 STD series Depressor Screen ø57cm. Stainless Steel. For models FRS-40 STD series	
3	250012 250010	Hose Cuff, ø25.4mm Static Conductive, black Crushproof Suction Hose, ø25.4mm, Static Conductive (no wire), black / meter (0.9 meter required)	
4	500159	Clamp, size 32, for hose end	
5	211685	Street Elbow, ø19mm, Stainless Steel	
6	212940	Nipple, ø19mm NPT x 2" LG, Stainless Steel	
7	212101A 212103A	Poly Liner, Static Dissipating, with draw string for the recovery of fine dust. For models FRS-17 STD series Poly Liner, Static Dissipating, with draw string for the recovery of fine dust. For models FRS-40 STD series	

## Water and Oil Separators for Filtration Recovery System (FRS)

8	214200	Water Separator, ø19mm	
9	214194	Oil Separator, ø12.7mm	

**\*Promotional Price**

**CATRIDGE FOR REVERSE PULSE/PURGE**

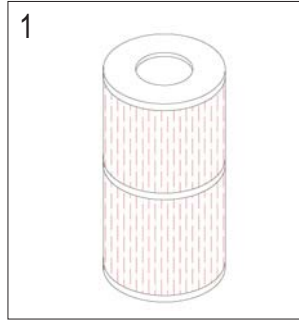

1	213435	Reverse Pulse Filter Cartridge. Made of spun bond polyester. 66cm high x 10cm ID x 24cm OD. For model FRS-40 STD (RPS)	
	214179	Reverse Purge Filter Cartridge. Made of spun bond polyester with PTFE membrane. 37.161 cm². For models 2D-11 (DT) MRP, 4D-11 (DT) MRP and CS-11 (DT) MRP	
	214211	Reverse Pulse Filter Cartridge. Made of spun bond polyester with PTFE membrane. 66cm high x 21cm ID x 32cm OD. For model FRS-17 STD (RPS)	

**OPTIONAL HEPA/ULPA FILTRATION**

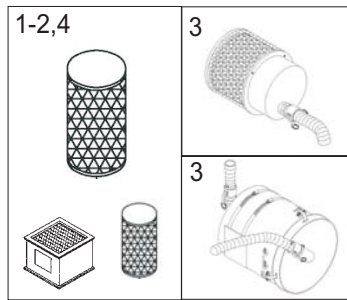

1	211027B	<b>HEPA Filter - efficiency of 99.995% on 0.3 micron. H14 as per MPPS method EN 1822.</b> For models 2D-11 (DT) MRP, 4D-11 (DT) MRP, 2D-14 (4W), 2D-15 (DECOM), 2D-15 HOSPITAL, B-4 DS, B-7 DS, B-8, 2D-15 (TC), 2D-16 (TC), 2D-25 (TC), 4D-25 (TC), 4D-57 (TC), BL-20 (DT) MFS, CD-1500 CR series,, CS-5 RE, CS-7 RE, CS-8 RE HEPA, CS-15 (TC) RE HEPA, CS-25 (TC) RE HEPA, CS-55 (TC) RE series, CS-11 (DT) MRP (RE) HEPA, CS-14 (4W) RE HEPA AND CS-27 (TC) RE HEPA	
	212202	For models 4D-14 (4W), 4D-27 (TC) AND CD-5000 series	
	212303	For models AS-5, AS-400 AND AS-400 MR	
	212304B	For models AV-20 DT (MFS) HEPA AND AVSD-20 DT (MFS) HEPA	
	213182	For models CD-2600 CR series AND ECO-55 (4W) series	
	213183	For models CD-10000 STD series AND CD-15000 series. For models CS-30 (CB) AND CS-55 (CB)	
2	211027	<b>ULPA Filter - efficiency of 99.9995% on 0.18 micron. U15 as per MPPS method EN 1822.</b> For models 4D-/CS-22 MR NUC HEPA AND CD-1500 series	
	212203	For model CD-3000 series	
3	213816	<b>HEPA Filters for Upstream and Downstream locations</b> HEPA Filter and Downstream Housing Assembly with ø64mm attachment. S/S**. For CD-10000 STD	
	213817	HEPA Filter and Upstream Housing Assembly with ø64mm attachment. S/S. For model CD-10000 STD	
	213818	HEPA Filter and Downstream Housing Assembly with ø100mm attachment. S/S**. For CD-15000 STD	
	213819	HEPA Filter and Upstream Housing Assembly with ø100mm attachment. S/S. For model CD-15000 STD	
4	213078	<b>HEPA Filter - Nuclear Grade</b> 30cm square Nuclear Grade UL-586 & ASME AG-1 Sec FC 3000 Specifications. For models 4D-CS-22 MR NUC	

SD\* - Static Dissipating

S/S\*\* - Stainless Steel AISI 304

THE ABOVE PRICES ARE EXPRESSED IN € EURO FOB BOLOGNA, ITALIA - PRICES SUBJECT TO CHANGE WITHOUT NOTICE

## OPTIONAL FILTRATION ACCESSORIES

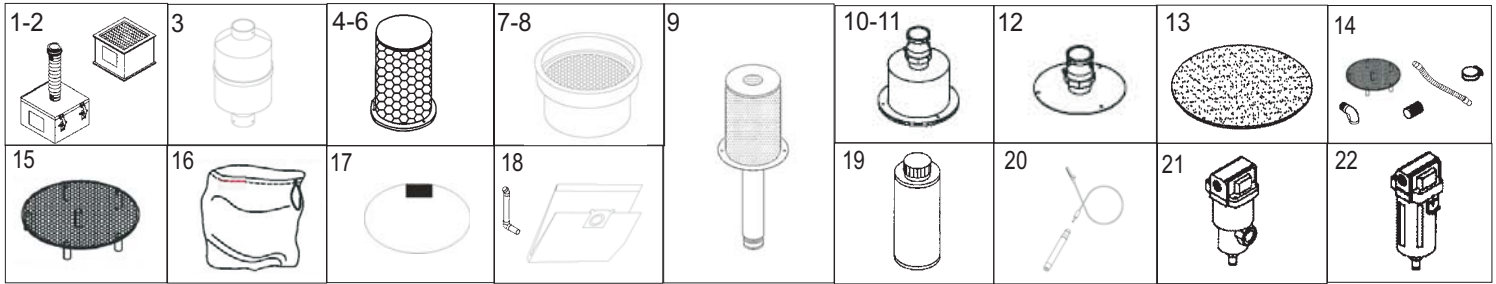

### \* Promotional Price

1	213079	HEPA Filter Assembly with Housing for 30cm square Nuclear Grade HEPA Filter. UL-586 & ASME AG-1. For models 4D/CS-22 MR NUC HEPA	
2	214082	Detachable HEPA/ULPA Housing Assembly with ULPA Filter	
3	214352A	Exhaust Silencer. ABS type. For model CD-1500 series	
4	212206	Perforated Housing for ULPA Filter # 212203. Stainless steel. For models CD-3000 CR & CD-5000 series	
5	213088	HEPA/ULPA Housing. Stainless Steel. For model CD-1500 series	
6	213197B	HEPA Housing. Powder Coated. For model CD-2600 CR series	
7	213348B	Carbon Cartridge with 8kg of 3mm regular carbon. For model CD-3000 (MRAC)	
	213348C	Carbon Cartridge with 8kg of 3mm Mersorb brand carbon for mercury vapors. For model CD-3000 (MRAC)	
	213348K	Carbon Cartridge with 8kg of 3mm Kina 3 brand carbon for chloride and acid vapors (JF, HCL, etc.) For model CD-3000 (MRAC)	
	213348L	Carbon Cartridge with 8kg of 3mm Nusorb A-3 brand carbon for arsine and phosphine. Also suitable for certain types of acid vapors. For model CD-3000 (MRAC)	
8	212200B	Carbon Cartridge with 8kg of 3mm regular carbon. For model CD-5000 (MRAC)	
	212200C	Carbon Cartridge with 8kg of 3mm Mersorb brand carbon for mercury vapors. For model CD-5000 (MRAC)	
	212200K	Carbon Cartridge with 8kg of 3mm Kina 3 brand carbon for chloride and acid vapors (JF, HCL, etc.) For model CD-5000 (MRAC)	
	212200L	Carbon Cartridge with 8kg of 3mm Nusorb A-3 brand carbon for arsine and phosphine. Also suitable for certain types of acid vapors. For model CD-5000 (MRAC)	
9	213380	Support Tube with Plate for Downstream ULPA Filter. Stainless steel. For model CD-1500 series	
10	212496A	Housing for ULPA filter with ø50mm male camlock. Allows for an exhaust hose to be used in conjunction with ULPA Filter # 211027. Stainless steel. Electropolished. For model CD-1500 series	
11	213004	Housing for ULPA filter with ø50mm male camlock. Allows for an exhaust hose to be used in conjunction with ULPA Filter # 212300. Stainless steel. For model CD-3000 CR and CD-5000 series	
12	213035	Adaptor Plate with ø50mm male camlock. Allows for an exhaust hose to be used with the vacuum cleaner without using the ULPA Filter. For models CD-1500 CR, CD-3000 CR and CD-5000 series	
13	212307	Foam Exhaust Filter. For model AS-5 HEPA	
14	214240	Depressor kit for poly liner recovery bag. For models FRS-17 STD series	
	214245	Depressor kit for poly liner recovery bag. For models FRS-40 STD series	
	214248	Depressor kit for poly liner recovery bag. For models 2D-20 (DT) MFS and AV-20 (DT) MFS	
15	213050B	Depressor screen, ø38cm, S/S**. For FRS-17 STD series	
	213898B	Depressor screen, ø57cm, S/S**. For FRS-40 STD series	
16	212367	Poly Liners (package of 5). For models 2D-11 (DT) MFS, 4D-11 (DT) MFS and BL-20 (DT) MRP	
	212370	Poly Liners (package of 5). For models 2D-14 (4W) and CS-14 (4W)	
	212374A	Poly Liners with print, 6mil. For model 2D-16 (TC)	
	212376	Poly Liners (package of 5). For model CS-27 (TC) RE	
	213184	Poly Liners (package of 5). For model 4D-14 (4W)	
	213185	Poly Liners (package of 5). For model 4D-27 (TC)	
	213340	Poly Liners (package of 5). For CD-5000 (SCFS)	
	214830	Poly Liners (package of 5). For CD-1500 CR (MCF)	
	214832	Poly Liners without hole (package of 5). For CD-1500 (PFB)	
	214987	Poly Liners with draw strings. For model AV-20 DT (MFS) HEPA and AVSD-20 DT (MFS) HEPA	
17	213780	Poly Liner Retainer Plate with Clip.	
18	211028	Latex Paper Filter Bags (package of 5). For models B-4DS series and B-8	
	211063	Paper Filter Bags (package of 5). For models 2D-15 (DECOM), 2D-15 Hospital and 2D-15 (TC)	
	211064	Paper Filter Bags (package of 5). For models 2D-16 (TC), 2D-25 (TC) and 4D-25 (TC)	
	211069	Latex Paper Filter Bags (package of 12). For model B-4DS Static Free	
	212300	Paper Filter Bags (package of 5). For model AS-5 HEPA	
	212500	Paper Filter Bags (package of 5). For models B-7DS and CD-1500 series	
	212535	Paper Filter Bags (package of 5). For models AS-400 and AS-400 MR	
	212994	Paper Filter Bags (package of 5). For models 2D-14 (4W), 4D-14 (4W) and CS-14 (4W)	
	211841	Connector for Paper Filter Bag	
19	211701	De-foaming liquid, 909 ml	
20	211065	Ground continuity tester (batteries not included)	
21	214200	Water Separator, ø19mm	
22	214194	Oil Separator, ø12.7mm	

SD\* - Static Dissipating

S/S\*\* - Stainless Steel AISI 304

THE ABOVE PRICES ARE EXPRESSED IN € EURO FOB BOLOGNA, ITALIA - PRICES SUBJECT TO CHANGE WITHOUT NOTICE

## MAIN CLOTH FILTERS

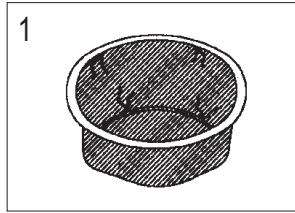

1	<p>211020 Main Filter Assembly. For models 4D-57, ECO-55 (4W) Wet &amp; Dry and CS-55 (TC) RE series</p> <p>211020A Main Filter with laces for filter cage. (Cage sold separately). For model ECO-55 (4W).</p> <p>211038A Main Filter Assembly with laces for filter cage. Washable. (Cage sold separately). For models 2D/CS-22 MR NUC HEPA</p> <p>211226 Double Cloth Filter Assembly. For models B-4 DS Series, CS-4 RE and CS-7 RE</p> <p>211265 Double Cloth Filter Assembly. For models B-7 DS, B-8 and CS-8 RE</p> <p>211430 Main Filter. For models CS-15 (TC) RE and CS-25 (TC) RE</p> <p>211430A Main Filter with laces for filter cage. (Cage sold separately). For model CS-5000 Series</p> <p>211430T Main Filter Assembly. PTFE laminated. For models 2D-15 (TC), 2D-16 (TC), 2D-25 (TC) and 4D-25 (TC)</p> <p>212003 Main Filter Assembly. For modes 4D-14 (4W) and 2D-27 (TC)</p> <p>212003A Main Filter Assembly with laces for filter cage. (Cage sold separately). For models 2D-14 (4W), BL-20 (DT) MFS, CS-14 (4W) and CS-27 (TC)</p> <p>212305 Cloth Filter. For model AS-5</p> <p>212385 Extra Large Cloth Filter with black plastic ring. For model AS-400 HEPA</p> <p>212803A Main Filter with laces for filter cage. (Cage sold separately). For model CD-3000 series</p> <p>212803AT Main Filter with laces. PTFE laminated Polyester Felt. (Cage sold separately). For model CD-1500 series</p> <p>214883A Main Filter Assembly with gasket and ring. Polyester. For model AV-20 SD (MFS) HEPA and AVSD-20 (MFS) HEPA</p> <p>214883AT Main Filter Assembly with laces, with gasket and ring. PTFE laminated Polyester. Efficiency of 99.95% on 0.5 micron. (Cage sold separately). For models AV-20 DT (MFS) HEPA and AVSD-20 DT (MFS) HEPA</p> <p>Main Filter. For models CS-30 (CB) and CS-55 (CB)</p> <p>Cloth Filter. For model AS-400 MR</p> <p>215194 Main Filter. For models AV-35 (STD) and AVSD-35 (STD)</p>
---	---

## CAGES FOR MAIN CLOTH FILTERS

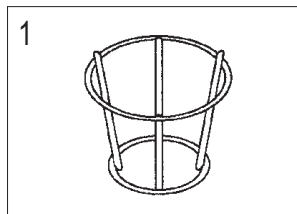

1	<p>212408A Cage for Main Filter. Electropolished. For model CD-3000 series</p> <p>212490 Cage for Filter. For model ECO-55 (4W) Dry only</p> <p>212734 Cage for Main Filter. For CD-5000 series</p> <p>213080B Cage for Main Filter. ø42cm x 13cm high x ø6.4mm ROD. Coated steel. For models 4D/CS-22 MR NUC</p> <p>213386A Cage for Main Filter. Stainless steel. Electropolished. For model CD-1500 series</p> <p>213186B Cage for Main Filter. Powder coated. For models 2D-14 (4W), BL-20 (DT) MFS, CS-14 (4W) &amp; CS-27 (TC)</p> <p>214880B Cage for Main Filter. Powder coated. For models AV-20 DT (MFS) HEPA and AVSD-20 DT (MFS) HEPA</p>
---	---

SD\* - Static Dissipating

S/S\*\* - Stainless Steel AISI 304

THE ABOVE PRICES ARE EXPRESSED IN € EURO FOB BOLOGNA, ITALIA - PRICES SUBJECT TO CHANGE WITHOUT NOTICE

## PRE-FILTERS

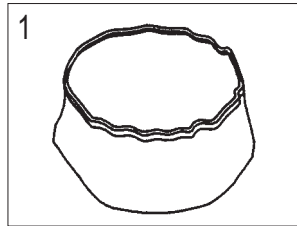

1	211021 212057 212811 213152 214884	<p>Dralon Pre-Filter Assembly. For models 4D-57, ECO-55 (4W) and CS-55 (TC) series</p> <p>Dralon Pre-Filter. For models 2D-14 (4W), 4D-14 (4W), 2D-27 (TC), CD-5000 (MRAC), CS-15 (TC) RE, CD-25 (TC) RE, CS-14 (4W) and CS-27 (TC)</p> <p>Dralon Pre-Filter Assembly with stainless steel ring. For model CS-3000 series</p> <p>Dralon Pre-Filter with snaps for Manual Filter Shaker (MFS). For model BL-20 (DT) MFS &amp; CD-5000 (SCFS)</p> <p>Dralon Pre-Filter only. For models 2D-20 (DT) MFS and AV-20 (DT) MFS</p>	

## LIQUID FILTERS

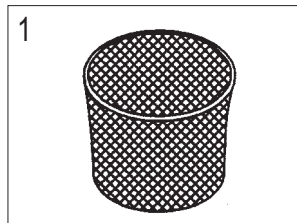

1	211017 211274 211394	<p>Liquid Filter. For models 4D-57, ECO-55 (4W) Wet &amp; Dry and CS-55 (TC) RE series</p> <p>Liquid Filter. For models B-8 and CS-8 RE</p> <p>Liquid Filter. For models 2D-15 (DECOM), 2D-15 HOSPITAL, 2D-15 (TC), 2D-16 (TC), 2D-25 (TC), CS-15 (TC) RE and CS-25 (TC) RE</p>	